

MANUALE D'USO - USER MANUAL

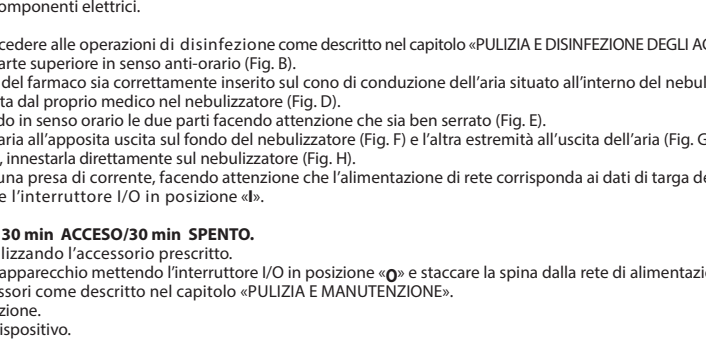
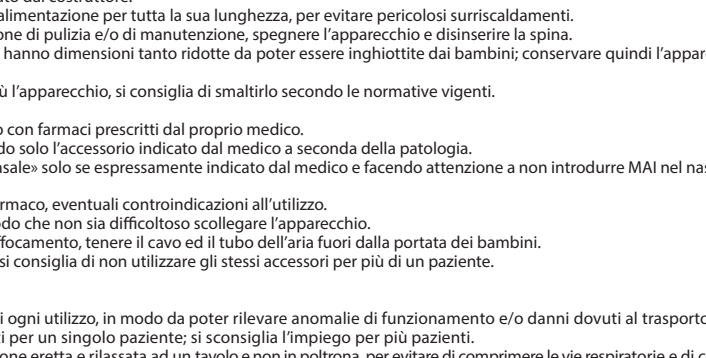
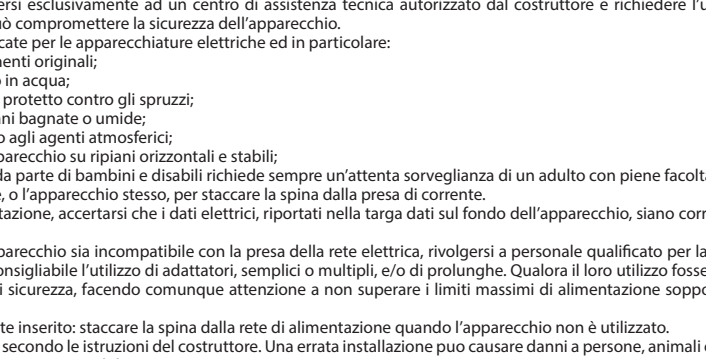
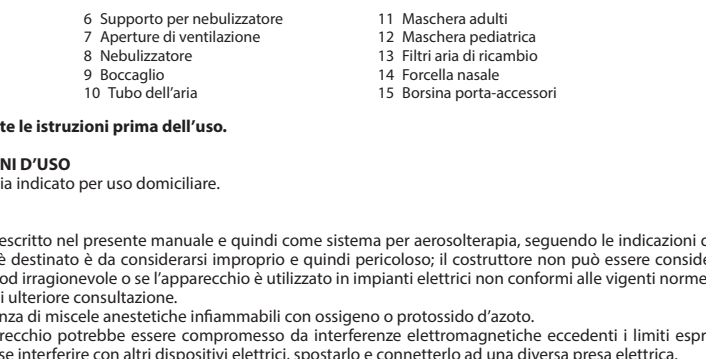
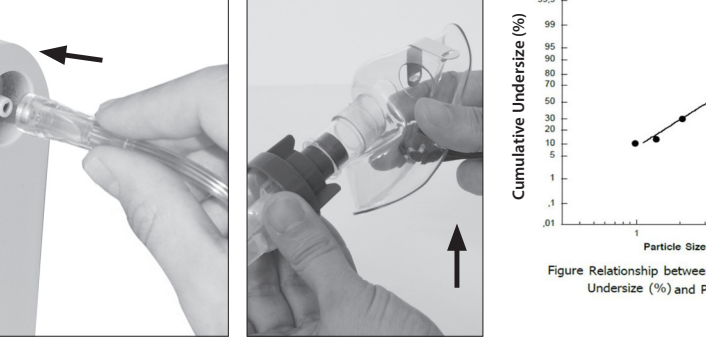
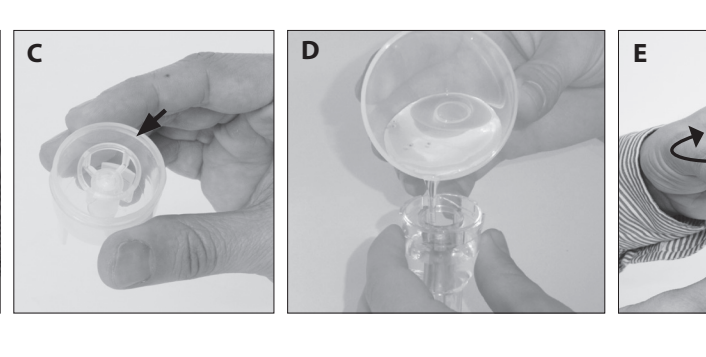
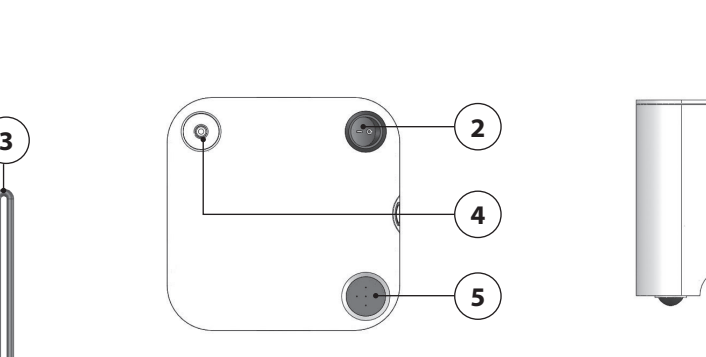
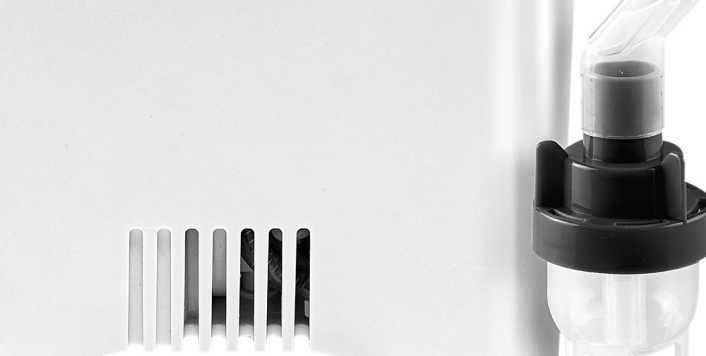

PULIZIA E MANUTENZIONE
La pulizia dell'apparecchio deve essere effettuata con un panno soffice ed asciutto e con sostanze detergenti non abrasive.
ATTENZIONE:
Durante l'esecuzione delle operazioni di pulizia, assicurarsi che non penetrino nell'apparecchio eventuali sostanze liquide e che la presa di corrente sia disinserita.

INSTALLAZIONE
Il nebulizzatore deve essere sostituito dopo una lunga inattività, nel caso in cui presenti deboli deformazioni o delle rotture, oppure nel caso in cui l'ugello del nebulizzatore sia ostruito da medicinale secco, polvere, ecc.
SOSTITUZIONE DEL FILTRO
Il filtro va sostituito ogni 200 ore circa di funzionamento o quando assume una colorazione grigia; per la sostituzione, aprire il porta-filtro (Fig. A/5) e sostituire il filtro (Fig. A/13) con un nuovo.

COMPONENTI E LORO SOLUZIONE
Problema
1. L'apparecchio non accende
2. L'apparecchio non nebulizza o nebulizza debolmente
3. Accertarsi che la spina sia inserita nella presa di corrente
4. Accertarsi che l'apparecchio non abbia superato i limiti di funzionamento indicati in questo manuale (30 min ACCESORIO/30 min SPENUTO).

CONDIZIONI AMBIENTALI
Ambiente/Transport
Temperatura: MIN 25°C - MAX 40°C
Umidità: MIN 10%RH - MAX 95%RH
Pressione: MIN 1098hPa - MAX 959hPa
Livello sonoro: 52 dBA

CONDIZIONI AMBIENTALI (cont.)
Funzionamento
Temperatura: MIN 10°C - MAX 40°C
Umidità: MIN 10%RH - MAX 95%RH
Altezza: da 2 a 2000m s.l.m.

CONDIZIONI AMBIENTALI (cont.)
EN MEDELA EASY COMPONENTS - (P.C.) A
1. Compresor housing
2. ON/OFF switch
3. Power cord
4. Air outlet
5. Filter
6. Nebulizer holder
7. Air-vent openings
8. Nebulizer
9. Mouthpiece
10. Spare air filters
11. Adult mask
12. Pediatric mask
13. Spare air filters
14. Nosepiece
15. Accessories

CONDIZIONI AMBIENTALI (cont.)
GENERAL INFORMATION / INTENDEE USE
Medel Easy is an aerosol therapy system suitable for domestic use.
1. Use the device only as described in this manual and therefore as an aerosol therapy system, following the indications of your doctor. Any use different from the intended one is to be considered improper and hence dangerous; the manufacturer cannot be held liable for any damage caused by improper, incorrect and/or unreasonable use of the equipment if it is connected to electrical installations which do not comply with current safety regulations.

CONDIZIONI AMBIENTALI (cont.)
GENERAL INFORMATION / INTENDEE USE (cont.)
1. Use the device only as described in this manual and therefore as an aerosol therapy system, following the indications of your doctor. Any use different from the intended one is to be considered improper and hence dangerous; the manufacturer cannot be held liable for any damage caused by improper, incorrect and/or unreasonable use of the equipment if it is connected to electrical installations which do not comply with current safety regulations.

CONDIZIONI AMBIENTALI (cont.)
GENERAL INFORMATION / INTENDEE USE (cont.)
1. Use the device only as described in this manual and therefore as an aerosol therapy system, following the indications of your doctor. Any use different from the intended one is to be considered improper and hence dangerous; the manufacturer cannot be held liable for any damage caused by improper, incorrect and/or unreasonable use of the equipment if it is connected to electrical installations which do not comply with current safety regulations.

CONDIZIONI AMBIENTALI (cont.)
GENERAL INFORMATION / INTENDEE USE (cont.)
1. Use the device only as described in this manual and therefore as an aerosol therapy system, following the indications of your doctor. Any use different from the intended one is to be considered improper and hence dangerous; the manufacturer cannot be held liable for any damage caused by improper, incorrect and/or unreasonable use of the equipment if it is connected to electrical installations which do not comply with current safety regulations.

CONDIZIONI AMBIENTALI (cont.)
GENERAL INFORMATION / INTENDEE USE (cont.)
1. Use the device only as described in this manual and therefore as an aerosol therapy system, following the indications of your doctor. Any use different from the intended one is to be considered improper and hence dangerous; the manufacturer cannot be held liable for any damage caused by improper, incorrect and/or unreasonable use of the equipment if it is connected to electrical installations which do not comply with current safety regulations.

CONDIZIONI AMBIENTALI (cont.)
GENERAL INFORMATION / INTENDEE USE (cont.)
1. Use the device only as described in this manual and therefore as an aerosol therapy system, following the indications of your doctor. Any use different from the intended one is to be considered improper and hence dangerous; the manufacturer cannot be held liable for any damage caused by improper, incorrect and/or unreasonable use of the equipment if it is connected to electrical installations which do not comply with current safety regulations.

CONDIZIONI AMBIENTALI (cont.)
GENERAL INFORMATION / INTENDEE USE (cont.)
1. Use the device only as described in this manual and therefore as an aerosol therapy system, following the indications of your doctor. Any use different from the intended one is to be considered improper and hence dangerous; the manufacturer cannot be held liable for any damage caused by improper, incorrect and/or unreasonable use of the equipment if it is connected to electrical installations which do not comply with current safety regulations.

CONDIZIONI AMBIENTALI (cont.)
GENERAL INFORMATION / INTENDEE USE (cont.)
1. Use the device only as described in this manual and therefore as an aerosol therapy system, following the indications of your doctor. Any use different from the intended one is to be considered improper and hence dangerous; the manufacturer cannot be held liable for any damage caused by improper, incorrect and/or unreasonable use of the equipment if it is connected to electrical installations which do not comply with current safety regulations.

CONDIZIONI AMBIENTALI (cont.)
GENERAL INFORMATION / INTENDEE USE (cont.)
1. Use the device only as described in this manual and therefore as an aerosol therapy system, following the indications of your doctor. Any use different from the intended one is to be considered improper and hence dangerous; the manufacturer cannot be held liable for any damage caused by improper, incorrect and/or unreasonable use of the equipment if it is connected to electrical installations which do not comply with current safety regulations.

CONDIZIONI AMBIENTALI (cont.)
GENERAL INFORMATION / INTENDEE USE (cont.)
1. Use the device only as described in this manual and therefore as an aerosol therapy system, following the indications of your doctor. Any use different from the intended one is to be considered improper and hence dangerous; the manufacturer cannot be held liable for any damage caused by improper, incorrect and/or unreasonable use of the equipment if it is connected to electrical installations which do not comply with current safety regulations.

CONDIZIONI AMBIENTALI (cont.)
GENERAL INFORMATION / INTENDEE USE (cont.)
1. Use the device only as described in this manual and therefore as an aerosol therapy system, following the indications of your doctor. Any use different from the intended one is to be considered improper and hence dangerous; the manufacturer cannot be held liable for any damage caused by improper, incorrect and/or unreasonable use of the equipment if it is connected to electrical installations which do not comply with current safety regulations.

CONDIZIONI AMBIENTALI (cont.)
GENERAL INFORMATION / INTENDEE USE (cont.)
1. Use the device only as described in this manual and therefore as an aerosol therapy system, following the indications of your doctor. Any use different from the intended one is to be considered improper and hence dangerous; the manufacturer cannot be held liable for any damage caused by improper, incorrect and/or unreasonable use of the equipment if it is connected to electrical installations which do not comply with current safety regulations.

CONDIZIONI AMBIENTALI (cont.)
GENERAL INFORMATION / INTENDEE USE (cont.)
1. Use the device only as described in this manual and therefore as an aerosol therapy system, following the indications of your doctor. Any use different from the intended one is to be considered improper and hence dangerous; the manufacturer cannot be held liable for any damage caused by improper, incorrect and/or unreasonable use of the equipment if it is connected to electrical installations which do not comply with current safety regulations.

CONDIZIONI AMBIENTALI (cont.)
GENERAL INFORMATION / INTENDEE USE (cont.)
1. Use the device only as described in this manual and therefore as an aerosol therapy system, following the indications of your doctor. Any use different from the intended one is to be considered improper and hence dangerous; the manufacturer cannot be held liable for any damage caused by improper, incorrect and/or unreasonable use of the equipment if it is connected to electrical installations which do not comply with current safety regulations.

CONDIZIONI AMBIENTALI (cont.)
GENERAL INFORMATION / INTENDEE USE (cont.)
1. Use the device only as described in this manual and therefore as an aerosol therapy system, following the indications of your doctor. Any use different from the intended one is to be considered improper and hence dangerous; the manufacturer cannot be held liable for any damage caused by improper, incorrect and/or unreasonable use of the equipment if it is connected to electrical installations which do not comply with current safety regulations.

CONDIZIONI AMBIENTALI (cont.)
GENERAL INFORMATION / INTENDEE USE (cont.)
1. Use the device only as described in this manual and therefore as an aerosol therapy system, following the indications of your doctor. Any use different from the intended one is to be considered improper and hence dangerous; the manufacturer cannot be held liable for any damage caused by improper, incorrect and/or unreasonable use of the equipment if it is connected to electrical installations which do not comply with current safety regulations.

CONDIZIONI AMBIENTALI (cont.)
GENERAL INFORMATION / INTENDEE USE (cont.)
1. Use the device only as described in this manual and therefore as an aerosol therapy system, following the indications of your doctor. Any use different from the intended one is to be considered improper and hence dangerous; the manufacturer cannot be held liable for any damage caused by improper, incorrect and/or unreasonable use of the equipment if it is connected to electrical installations which do not comply with current safety regulations.

CONDIZIONI AMBIENTALI (cont.)
GENERAL INFORMATION / INTENDEE USE (cont.)
1. Use the device only as described in this manual and therefore as an aerosol therapy system, following the indications of your doctor. Any use different from the intended one is to be considered improper and hence dangerous; the manufacturer cannot be held liable for any damage caused by improper, incorrect and/or unreasonable use of the equipment if it is connected to electrical installations which do not comply with current safety regulations.

CONDIZIONI AMBIENTALI (cont.)
GENERAL INFORMATION / INTENDEE USE (cont.)
1. Use the device only as described in this manual and therefore as an aerosol therapy system, following the indications of your doctor. Any use different from the intended one is to be considered improper and hence dangerous; the manufacturer cannot be held liable for any damage caused by improper, incorrect and/or unreasonable use of the equipment if it is connected to electrical installations which do not comply with current safety regulations.



